

PLAYER SERVICES

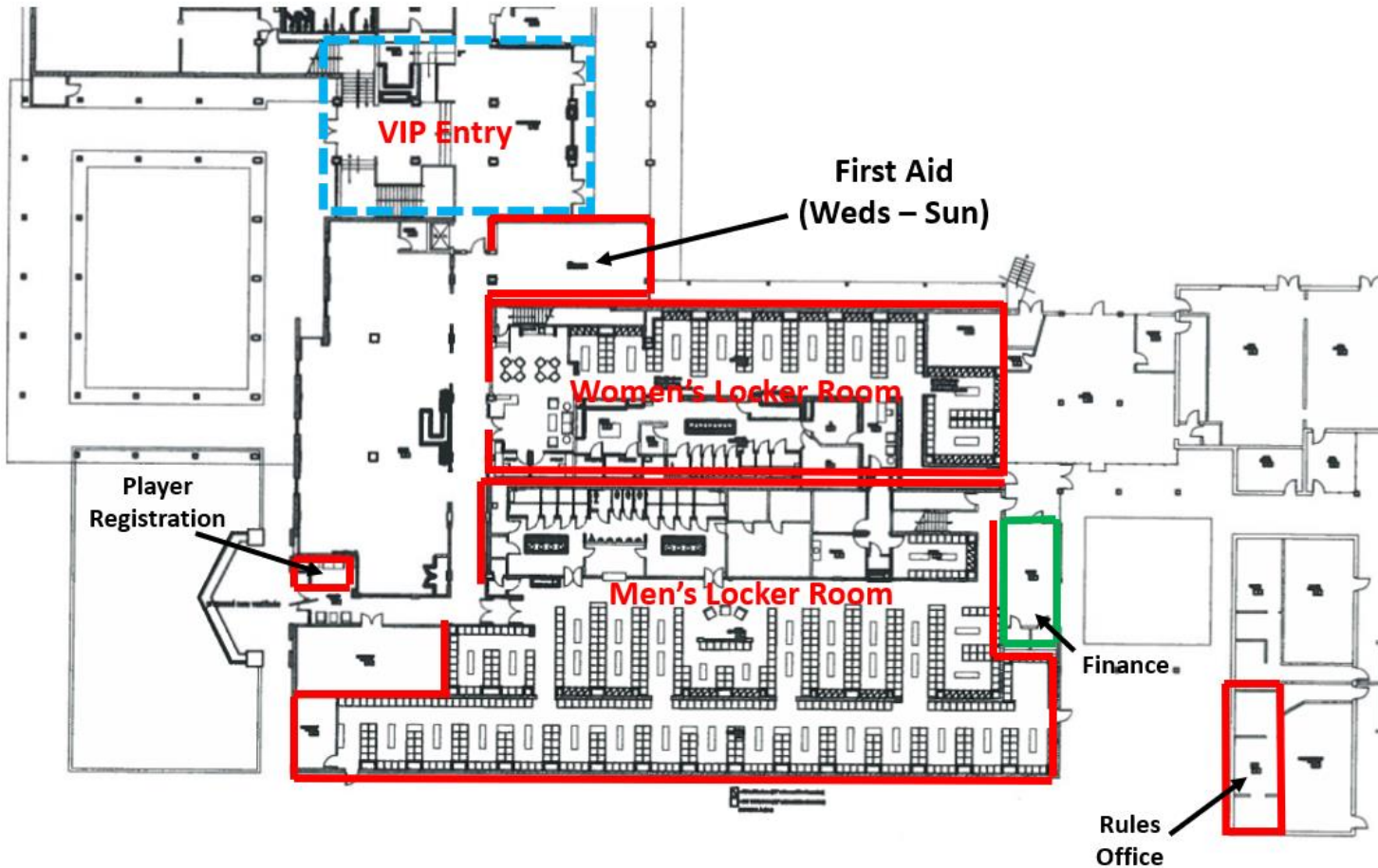

PCC – First Floor



PCC – Second Floor

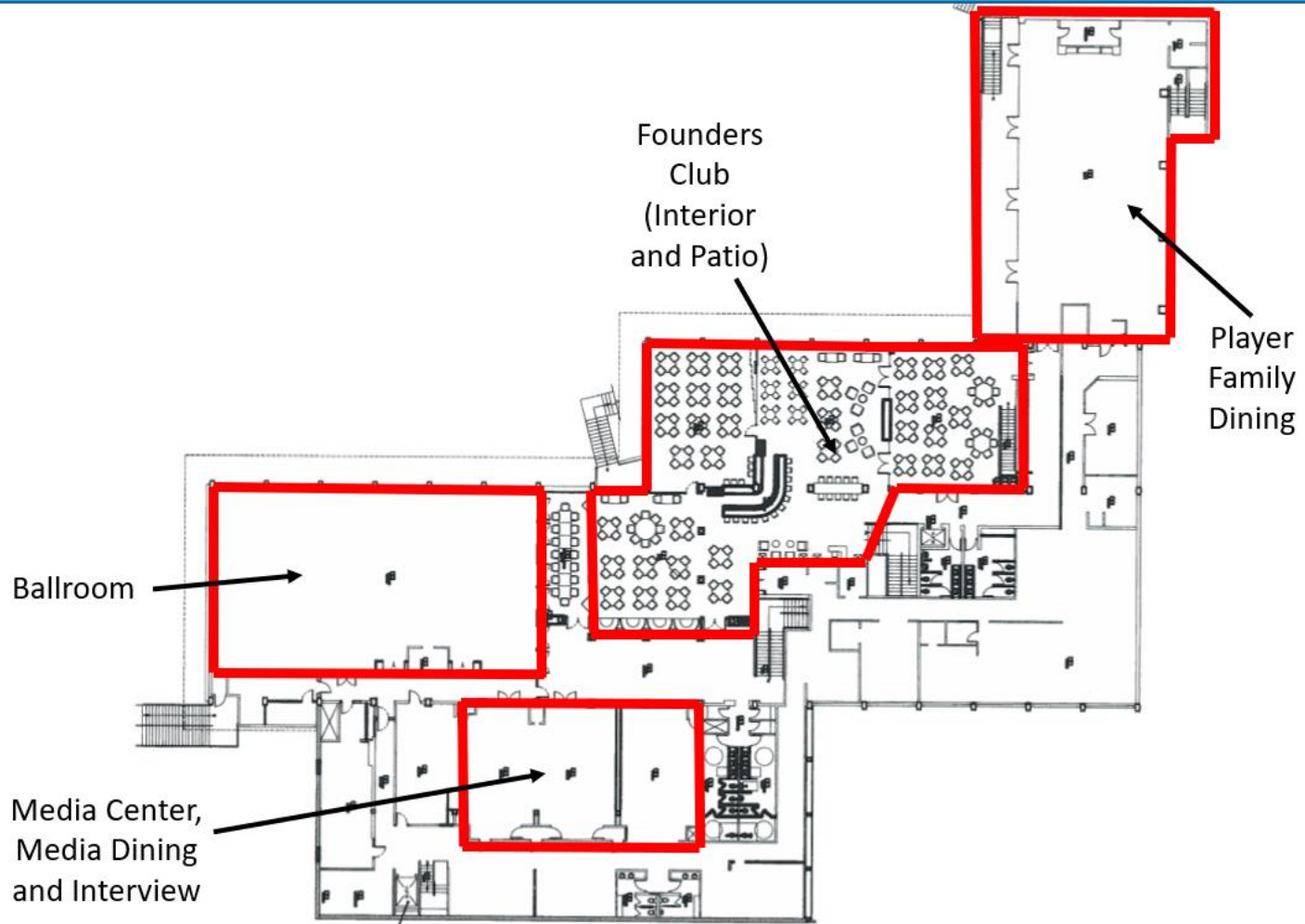

PCC – Women's Locker Room

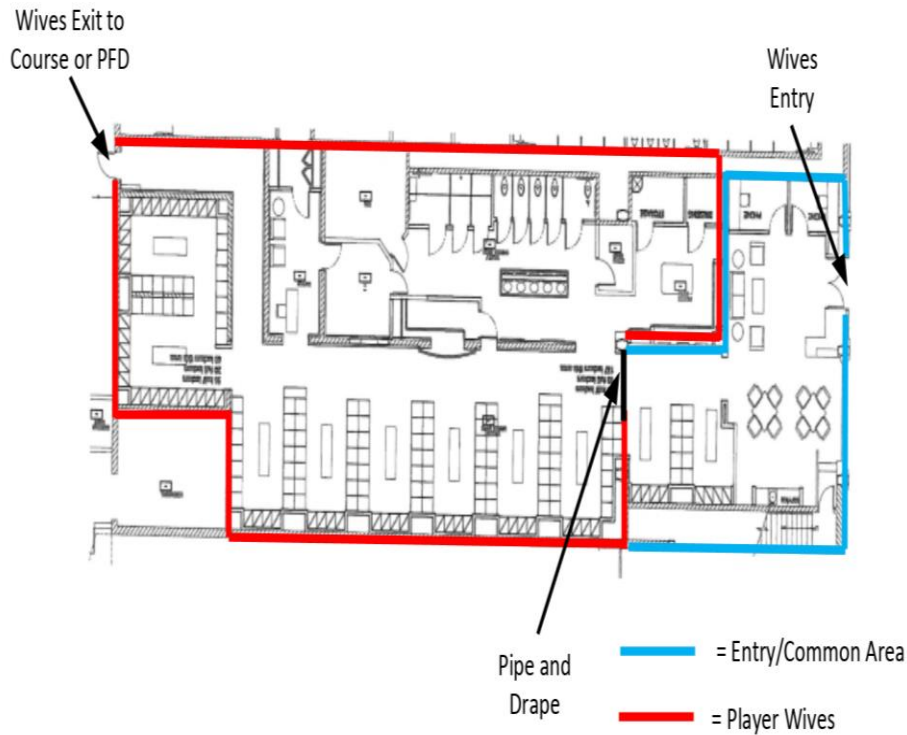

PCC – First Floor (President's Room)

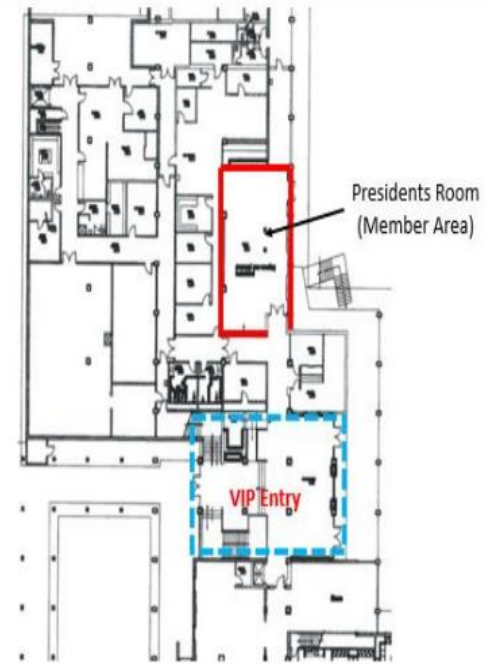

PCC – Men's Locker Room

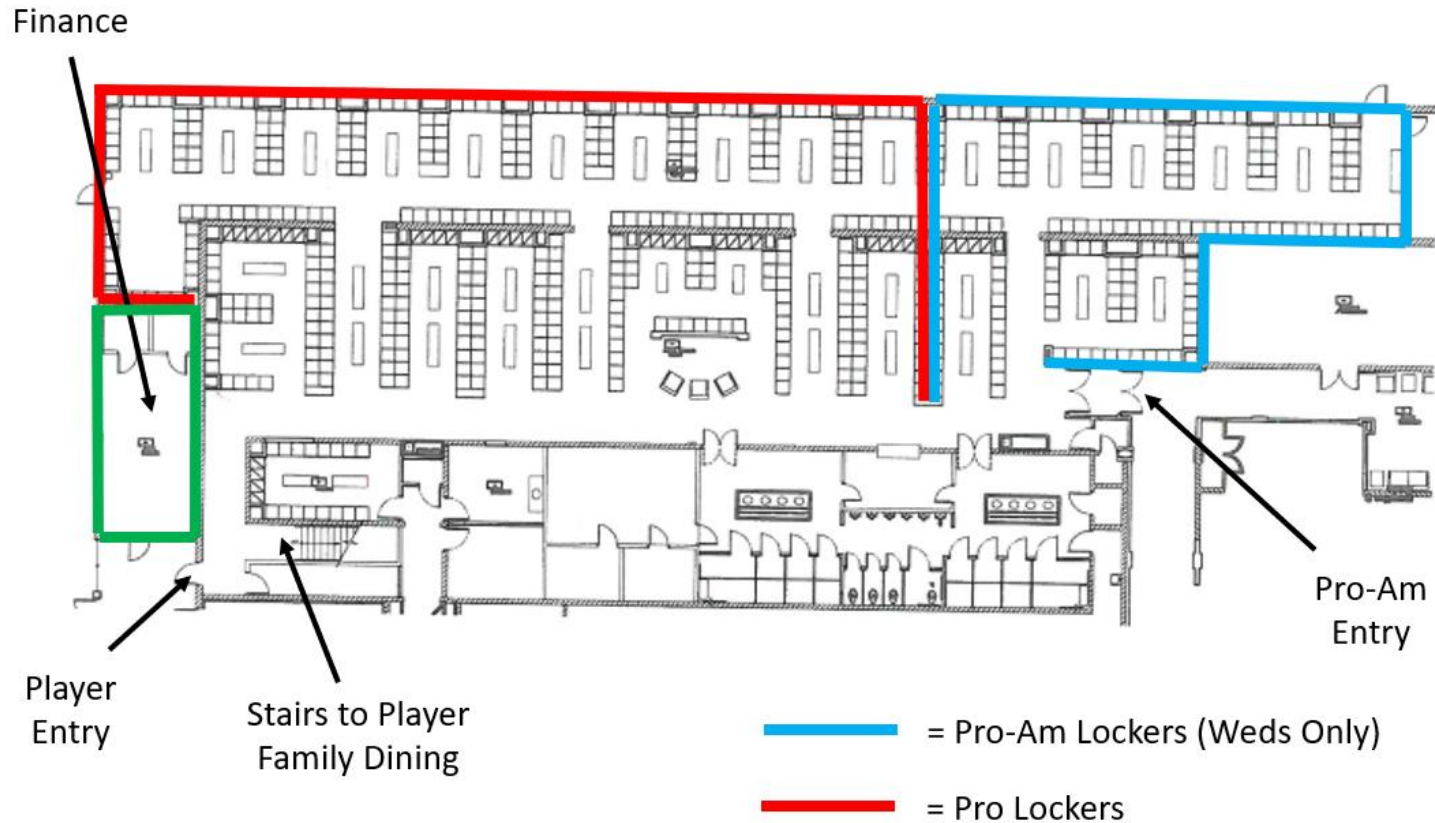

Monday – Tuesday

Volunteers will assist PGA TOUR Champions Staff with
Player Registration

Wednesday – Sunday

Player and Player Spouse Concierge Service

Inquiries may include but are not limited to:

- Restaurant recommendations
- Medical needs
- Travel Requests
- Courtesy Car Service

Location: Member Entrance, adjacent to the Player Parking Lot

Staff: PGA TOUR Champions Operations Team

Time/Date:

- Monday: 8:00am – 5:00pm
- Tuesday: 8:00am – 5:00pm

Registration Process for Players:

- Arrive Phoenix Country Club and immediately register
- Register via iPad
- Receive a Player Packet that includes:
 - Player Handbook
 - Yardage Book
 - List of Restaurants (provided by host hotels)
- Packets will be pre-packed and organized alphabetically by Tournament Staff

FINAL FIELD & ARRIVALS

- Commitment list is due Friday, November 4th
- The final field is set on Sunday, November 6th
- Players will arrive Sunday, November 6 – Tuesday, November 8
- PGA TOUR Global Home will provide a field list with player headshots to Player Services from PGA TOUR HQ

- Courtesy cars will be provided by San Tan Ford for the 2022 Charles Schwab Cup Championship

Player Transportation

- Each PGA TOUR Champions professional will receive one (1) courtesy car the week of the tournament.
- Transportation Committee Chairman:
 - Andres Kraemer
transportation@golf-volunteers.com
Cell: 703.395.5856
- PGA TOUR Contact:
 - Nikki Paine
nikkipaine@pgatourhq.com
Cell: 662.603.4861

- Players will park in Lot 1 of the Phoenix Country Club
- Players will receive a Lot 1 parking pass if using personal vehicle but do not need one since they are driving a courtesy car



- **Player Family Dining:** Players and Spouses
- **Locker Room:** Players Only, Manufacturer Reps (with proper credentials; must have an L on badge)
- **Practice Facility:** Players and (1) Coach, Instructor, Interpreter or Manufacturer Rep
- **Physio Trailers:** Players Only
- **Scoring:** Players Only
- **Media Flash Interview:** Players Only

Access to Player Family Dining is limited to Contestants, spouses and family. Must have proper credentials to access Player Family Dining – D access code

LOCATION

- Men's Grill (2nd floor of clubhouse)

FOOD SERVICE

- Multiple food options in Player Family Dining

Access to Player Family Dining is limited to contestants and spouses

BREAKFAST HOURS

Monday, November 7	CLOSED
Tuesday, November 8	7:00 a.m. – 11:00 a.m.
Wednesday, November 9	5:00 a.m. – 10:00 a.m.
Thursday, November 10	7:00 a.m. – 10:30 a.m.
Friday, November 11	7:00 a.m. – 10:30 a.m.
Saturday, November 12	7:00 a.m. – 10:30 a.m.
Sunday, November 13	7:00 a.m. – 10:30 a.m.

LUNCH HOURS

Monday, November 7	11:00 a.m. – 4:00 p.m.
Tuesday, November 8	11:00 a.m. – 4:00 p.m.
Wednesday, November 9	11:00 a.m. – 4:00 p.m.
Thursday, November 10	11:30 a.m. – 4:00 p.m.
Friday, November 11	11:30 a.m. – 4:00 p.m.
Saturday, November 12	11:30 a.m. – 4:00 p.m.
Sunday, November 13	11:30 a.m. – 4:00 p.m.

- Players or their caddies should visit the Phoenix Country Club Pro Shop with questions
- To coordinate practice rounds, communicate with Phoenix Country Club golf staff but no need to book times, go as you please
- Players will be permitted to use a golf cart for Practice Rounds and Official Pro-Am Day
- Player golf carts will be staged adjacent to the Phoenix Country Club Pro Shop

- Volunteers will receive a copy of the Player Handbook via email the week of November 1st
- Volunteers should familiarize themselves with the handbook and all the important details for players including Transportation Hours, Player/Family Dining, Caddie Information, Practice Areas, Medical Needs, etc.

PLAYER HANDBOOK

TOURNAMENT STAFF

Tiffany Nelson-Thorne, Executive Director

480-707-8275

Kristi Lee Fowlks, Tournament Service Manager

503-320-4317

Blake Kuehner, Operations Manager

480-242-7322

PLAYER SERVICES CHAIRMAN

Phil Hannaford

480-216-8256